



# **WELCOME TO CALIFORNIA SAFETY SUMMIT**

JULY 29TH, 2025



# WELCOME AND SAFETY MESSAGE

PRESENTED BY :  
DENNIS FALLON  
EXECUTIVE DIRECTOR  
UTILITY ARBORIST ASSOCIATION



# EVACUATION ROUTE

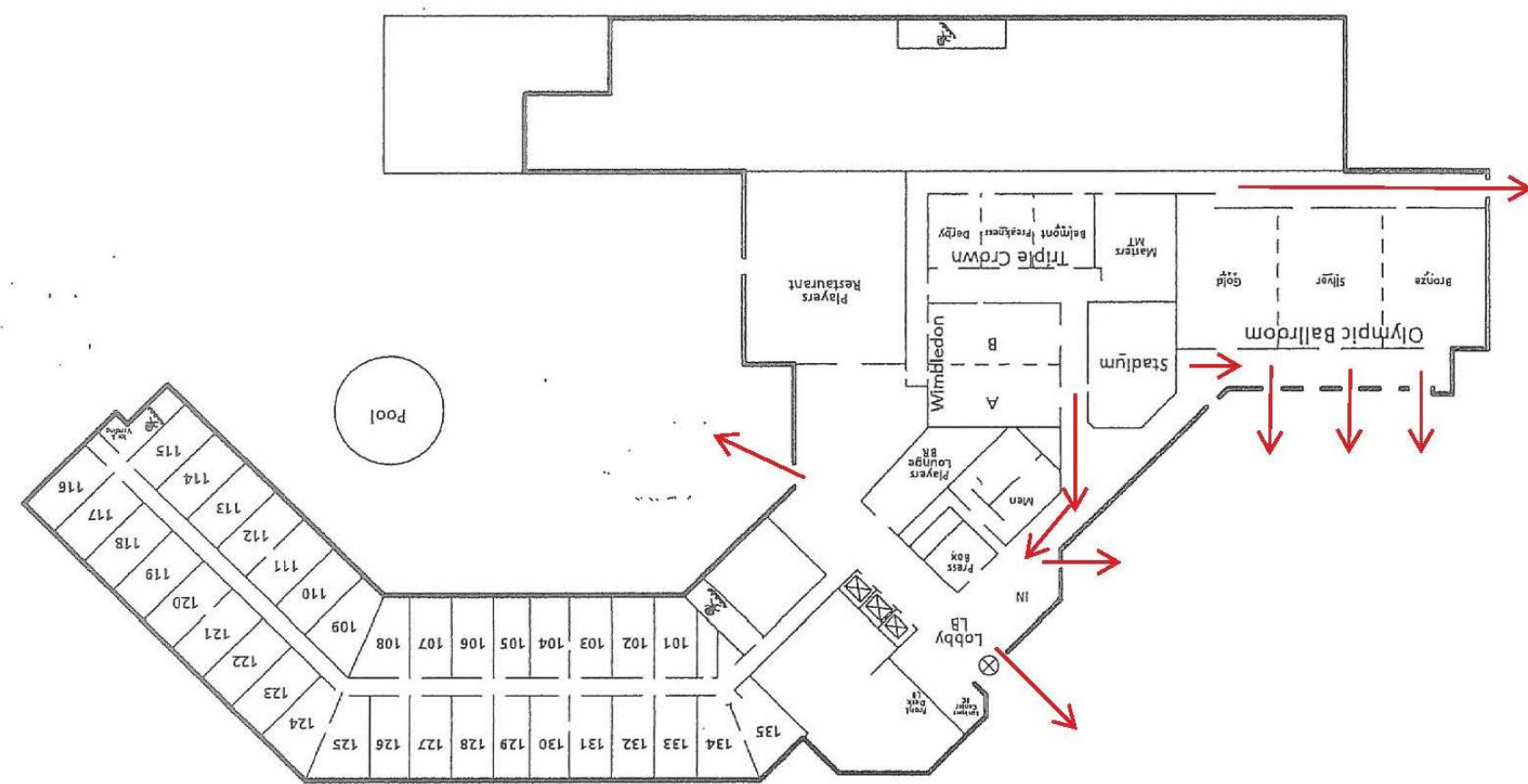



# THANK YOU TO OUR UTILITY HOST!



*Pacific Gas and  
Electric Company*®

---





# THANK YOU TO OUR AV ELITE SPONSOR!



# THANK YOU TO OUR GOLD LEVEL SPONSORS!





# THANK YOU TO OUR SILVER LEVEL SPONSOR!



SOUTHERN CALIFORNIA  
**EDISON**<sup>®</sup>

An *EDISON INTERNATIONAL*<sup>®</sup> Company



# THANK YOU TO OUR NETWORKING SPONSOR!





# KEYNOTE SPEAKER

MATT KRAUSE

DAVEY TREE SERVICES





# The Energy Wheel

## Safety Defined & Safety Differently



# Safety Defined

*Definition from Oxford Languages:*

- The condition of being protected from or unlikely to cause danger, risk, or injury.



# Safety Differently

Protecting and Caring for Employees

Energy Based Hazard Recognition

High Energy Hazards

Serious and Fatal Injury Identification

High Energy Controls

Human Performance

## Energy Based Hazard Recognition



**Suspended Load and Working at Heights**

**Tree Removal and Traffic**

**Mobile Equipment and Chipper**

**Electrical Conductors and Utilities**

**Tree Parts and Mechanical Equipment**



## Serious and Fatal Injury Recognition

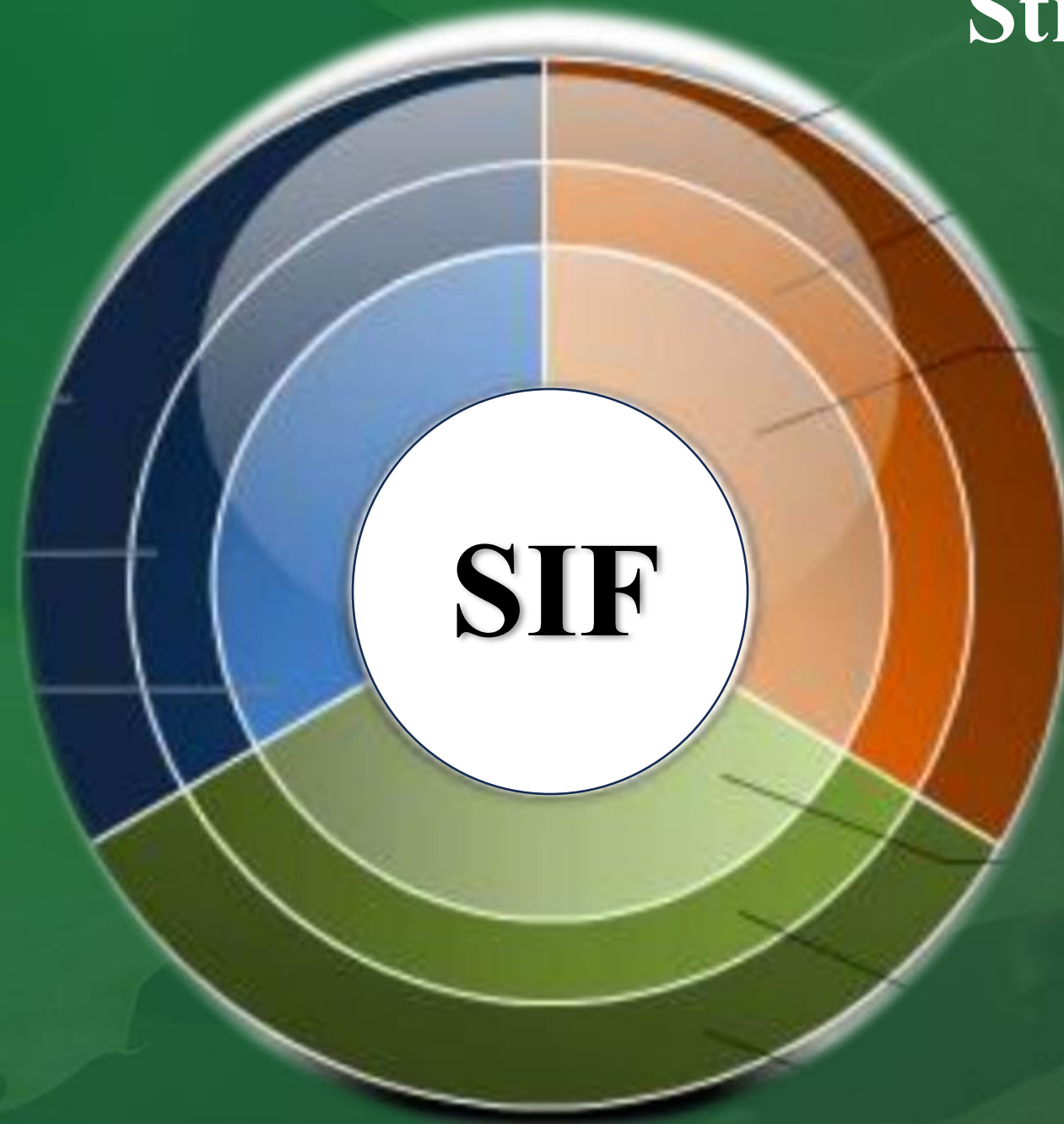

**Struck by Object**

**Electrical Contact**

**Fall from Heights**

**Employee In Drop Zone**

**One Hand Chainsaw Use**

**Improper or No Use of PPE**

**Free Climbing**

**Traffic Control Zones**





What Does Safety Look Like?

Hazard or Violation?

**DAVEY**  <sup>®</sup>  
*Proven Solutions for a Growing World*





**Job Plan**

**Worksite  
Support**

**Control**

**DAVEY**   
*Proven Solutions for a Growing World*



## The Serious Injury and Fatality Challenge Across All Industries

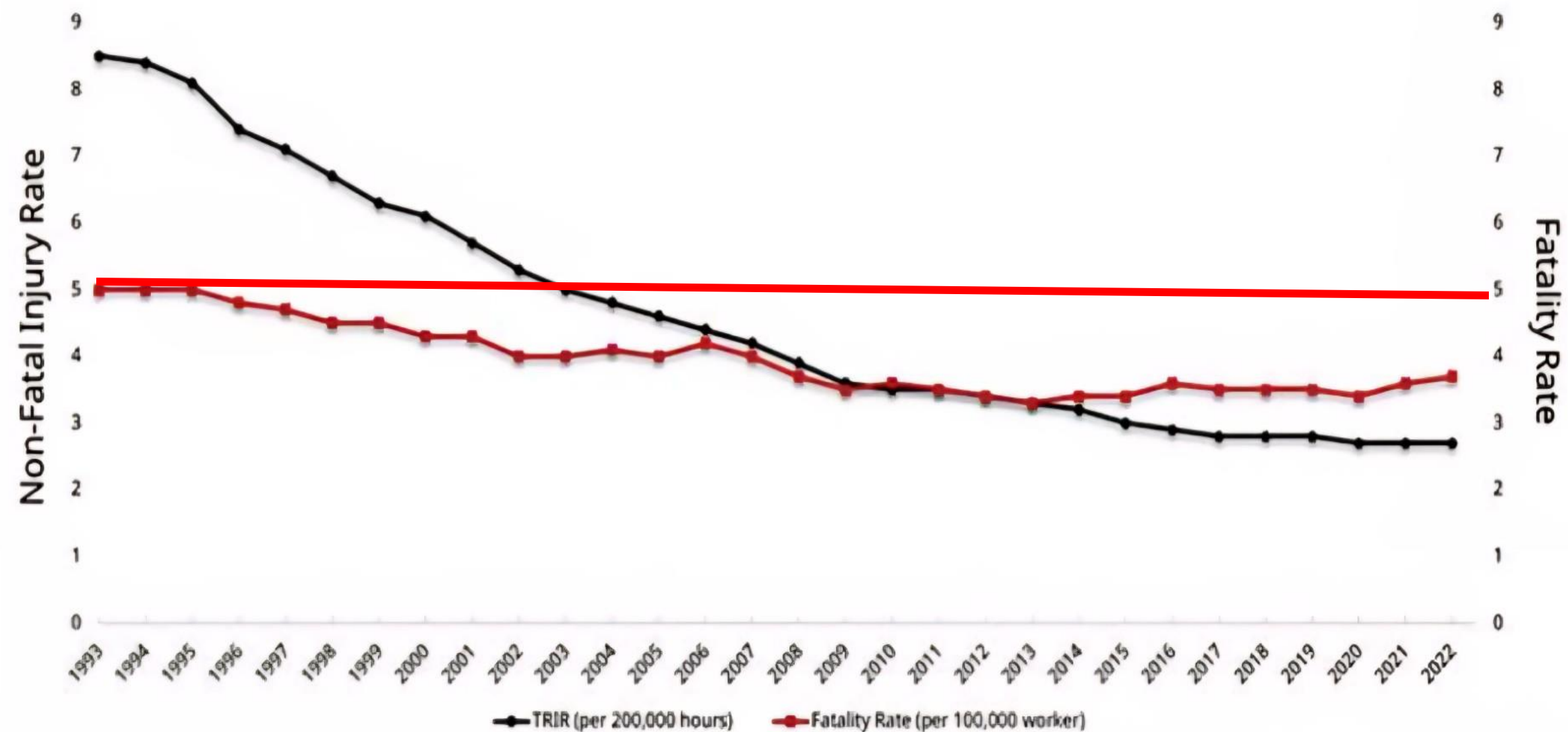

©2024 DEKRA North America, Inc. or its subsidiaries. All rights reserved. Confidential Information.

Source: U.S. Bureau of Labor Statistics



“Despite Decades of efforts, serious injuries and fatalities in the industry remain unchanged.”

©2024 DEKRA North America, Inc. or its subsidiaries. All rights reserved. Confidential Information.

Source: U.S. Bureau of Labor Statistics

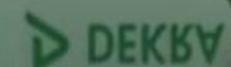

**DAVEY**   
Proven Solutions for a Growing World





STKY  
Situations That  
Can Cause  
Serious or Fatal  
Injuries.



# Risk Management & Risk Tolerance

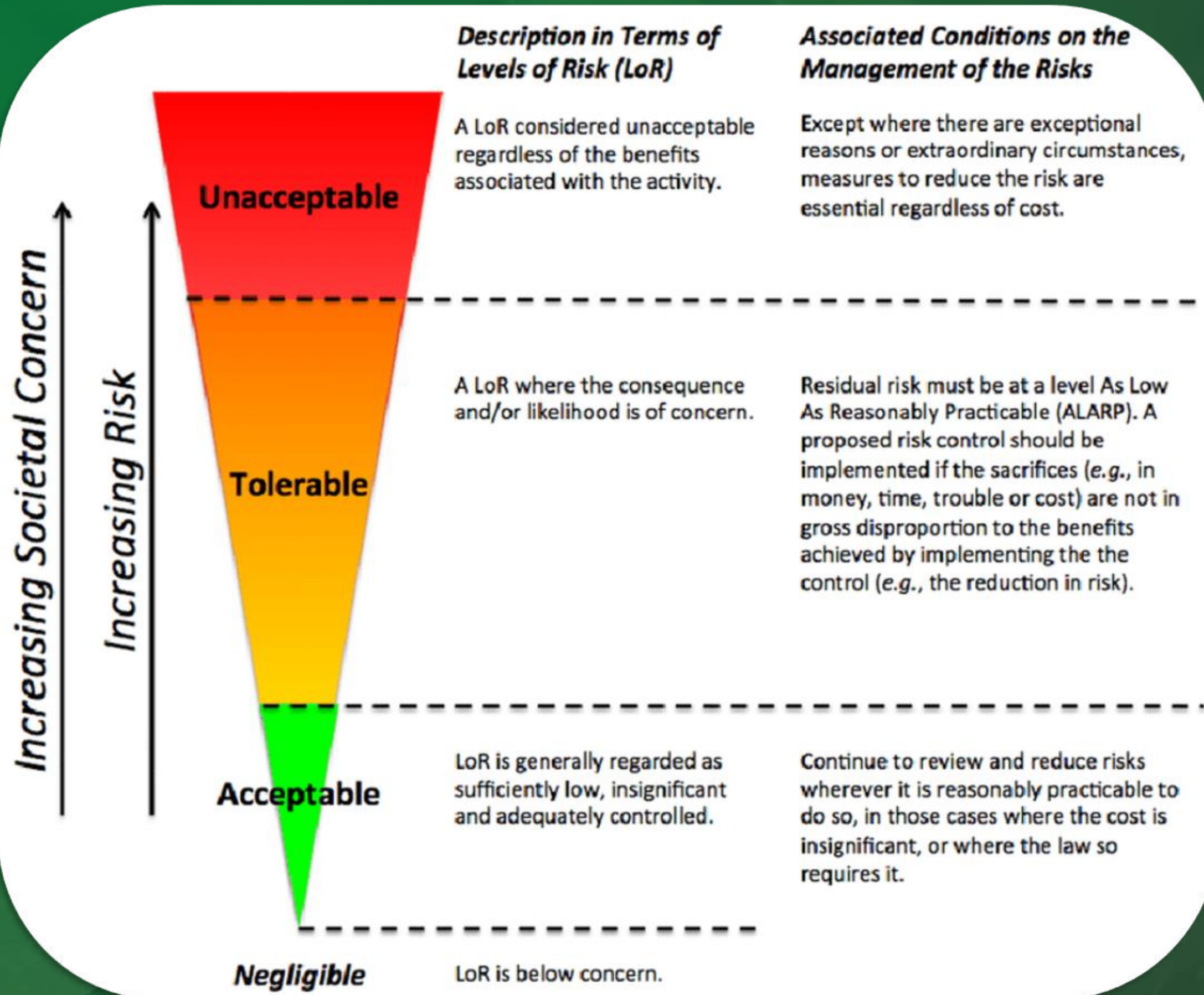



# Controls

## Direct Controls - *Key Characteristics*

**Targeted to High Energy Hazards** – Addresses high energy hazards that could cause SIF  
**Effectively Mitigates High Energy** – When properly installed, verified, and used  
**Immune to unintentional human error**

## Indirect Controls – *Examples*

**Training and Education** – Identifying hazards and educating safety procedures

**Safe Work Practices** – Implementing clear and detailed instructions to perform safely

**Signs and Warning Devices** – Implemented to alert the presence of potential hazards

**Subject to Human Error** and do not eliminate the hazard.

# Human Performance

HOP — *Definition*

Human and Organizational Performance

HPI — *Definition*

Human Performance Improvement —

Reasons for mistakes

Error likely situations

Error mitigation plan





Work Force Education & Training

# Open Ended Questions and Employee Engagement





## The Energy Wheel Recap and Review



**Safety Defined**  
**Safety Differently**  
**Energy Based Hazard Recognition**  
**Serious and Fatal Injury Identification**  
**Risk Management and Risk Tolerance**  
**Direct and Indirect Controls**  
**Human Performance**  
**Improvement**



*Thank You For Your  
Time and Attention!*





# GROUP BREAKOUT: 10:15-11:15

GROUP #1: DIFFICULT TREE REMOVAL: DERBY

GROUP #2: TREES UNDER TENSION & CONDUCTORS: MASTERS

GROUP #3: LONE WORKER SAFETY: BELMONT

GROUP #4: THIRD PARTY THREATS : PREAKNESS

GROUP #5: Z133/ANSI UPDATES: OLYMPIC BALLROOM





# GROUP BREAKOUT: 11:20-12:15

GROUP #5: DIFFICULT TREE REMOVAL: DERBY

GROUP #1: TREES UNDER TENSION & CONDUCTORS: MASTERS

GROUP #2: LONE WORKER SAFETY: BELMONT

GROUP #3: THIRD PARTY THREATS : PREAKNESS

GROUP #4: Z133/ANSI UPDATES: OLYMPIC BALLROOM



12:15-1:15

LUNCH IS SERVED!

## MENU

### SOUTH OF THE BORDER BUFFET:

- Mixed green salad with jicama, black beans & queso fresco with citrus vinaigrette dressing Green cabbage & mango salad with tequila lime vinaigrette dressing Grilled chipotle chicken with sautéed onions & bell peppers Carne Asada strips marinated with cilantro, diced onions & lime Cheese enchiladas with green Chile sauce Refried pinto beans, Spanish rice & flour tortillas Black olives, diced tomatoes, sour cream, guacamole, shredded cheese, Shredded lettuce, sliced jalapenos & salsa Tres Leches cake





# GROUP BREAKOUT: 1:20-2:10

GROUP #4: DIFFICULT TREE REMOVAL: DERBY

GROUP #5: TREES UNDER TENSION & CONDUCTORS: MASTERS

GROUP #1: LONE WORKER SAFETY: BELMONT

GROUP #2: THIRD PARTY THREATS : PREAKNESS

GROUP #3: Z133/ANSI UPDATES: OLYMPIC BALLROOM



# GROUP BREAKOUT: 2:15-3:10

GROUP #3: DIFFICULT TREE REMOVAL: DERBY

GROUP #4: TREES UNDER TENSION & CONDUCTORS: MASTERS

GROUP #5: LONE WORKER SAFETY: BELMONT

GROUP #1: THIRD PARTY THREATS : PREAKNESS

GROUP #2: Z133/ANSI UPDATES: OLYMPIC BALLROOM





3:15-3:30  
STRETCH BREAK







# GROUP BREAKOUT: 3:30-4:25

GROUP #2: DIFFICULT TREE REMOVAL: DERBY

GROUP #3: TREES UNDER TENSION & CONDUCTORS: MASTERS

GROUP #4: LONE WORKER SAFETY: BELMONT

GROUP #5: THIRD PARTY THREATS : PREAKNESS

GROUP #1: Z133/ANSI UPDATES: OLYMPIC BALLROOM





# NOTETAKER MEETUP: 4:25 –5:25

- Note takers please stay behind to consolidate your notes for our Report Back Tomorrow
- Meet at the Staff Table

# WHAT'S NEXT

## NETWORKING EVENT

JOIN US TONIGHT ON THE  
PATIO FOR A NETWORKING  
RECEPTION PRESENTED BY  
WRIGHT TREE FROM  
5-8PM ON THE PATIO  
-DON'T FORGET YOUR  
DRINK TICKETS!

## TOMORROW'S OUTLOOK

TOMORROW BREAKFAST  
WILL START  
AT 7AM  
WELCOME MESSAGE  
BEGINS AT 8AM





# **WELCOME TO CALIFORNIA SAFETY SUMMIT**

**JULY 30, 2025**



# WELCOME AND SAFETY MESSAGE

PRESENTED BY :  
DENNIS FALLON  
EXECUTIVE DIRECTOR  
UTILITY ARBORIST ASSOCIATION







# THANK YOU TO OUR UTILITY HOST!



*Pacific Gas and  
Electric Company*®

---



# THANK YOU TO OUR AV ELITE SPONSOR!





# THANK YOU TO OUR GOLD LEVEL SPONSORS!



**Clear Path**  
**Utility Solutions, LLC**  
INNOVATION FOR TOMORROW

TREE SERVICE KINGS, INC.





# THANK YOU TO OUR SILVER LEVEL SPONSORS!



SOUTHERN CALIFORNIA  
**EDISON**<sup>®</sup>

An *EDISON INTERNATIONAL*<sup>®</sup> Company





# THANK YOU TO OUR NETWORKING SPONSOR!



# CO-PILOT PROGRAM

TODD PEABODY

MOUNTAIN F. ENTERPRISES, INC







# Mountain F. Enterprises, Inc. Co-Pilot Program

---

By Todd Peabody

07/2025

# Our Exposure



## Fleet Size

- 2023 – Avg. 728 On Highway Vehicles
- 2024 – Avg. 653 On Highway Vehicles
- 2025 – Avg. 655 On Highway Vehicles

## Miles Driver Per Year

- 2023 - 9,028,344 Miles Driven
- 2024 - 6,665,913 Miles Driven
- 2025 - 6,400,000 Estimated Miles Driven

07/2025







# The Issue

07/2025







# The Issue

07/2025







# The Inspiration

---

07/2025



# Implementation

---



Development



Training Video for Employees



Field Awareness Campaign



Written Programs



Audits & Compliance



Tracking System



Weekly Meetings

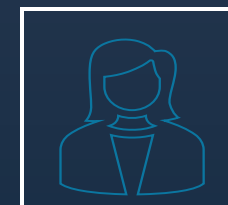

Additional Employees



07/2025



# Development

What Information Do Our Drivers and Co-Pilots Need to Be Successful?

- Safe Routing
- Local Weather Information
- Historic Incident Information (Dangerous Intersections/Areas)
- A Map of Approved/Restricted Roads

07/2025

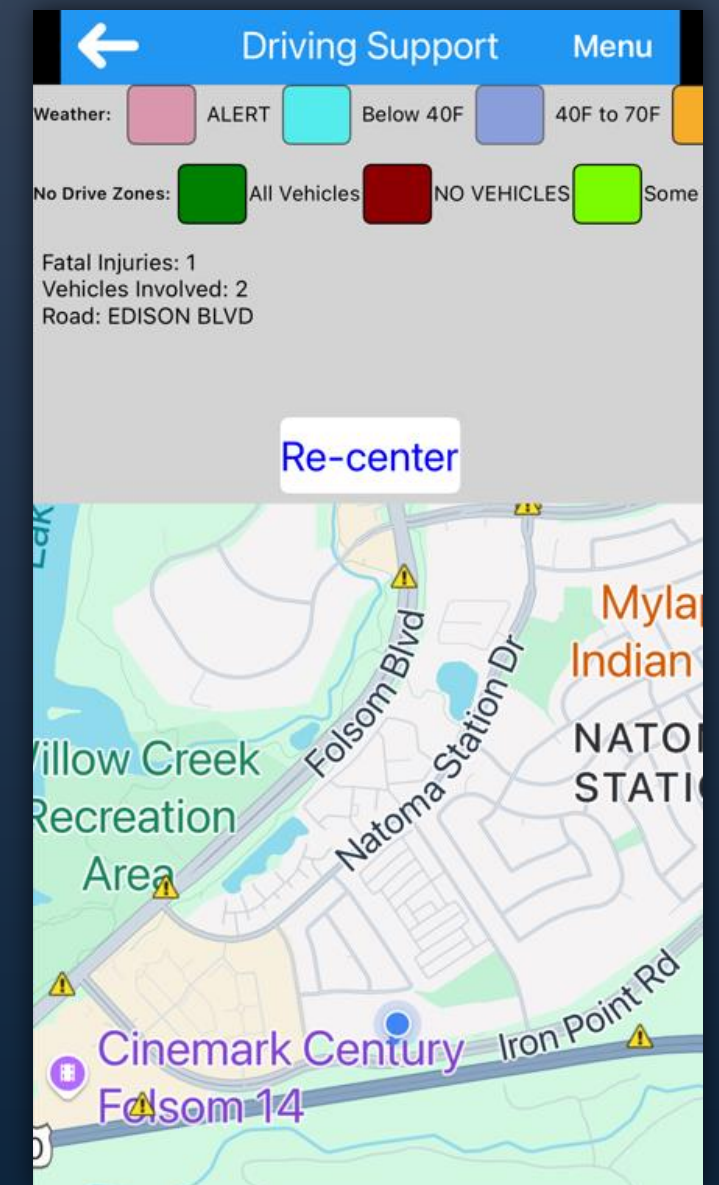

# Training Video for Employees

---

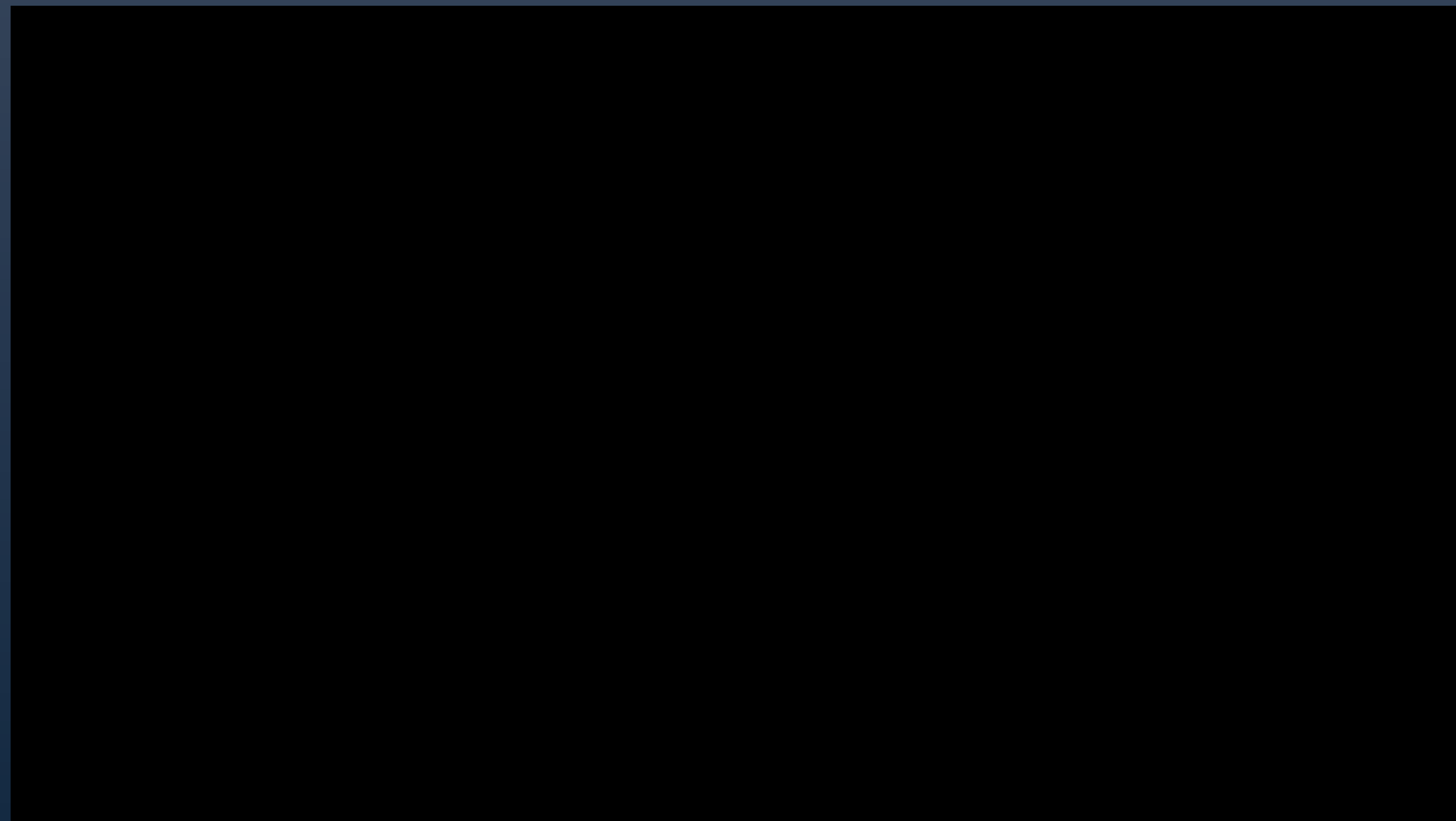



# Field Awareness Campaigns

## White Board Safety Meetings

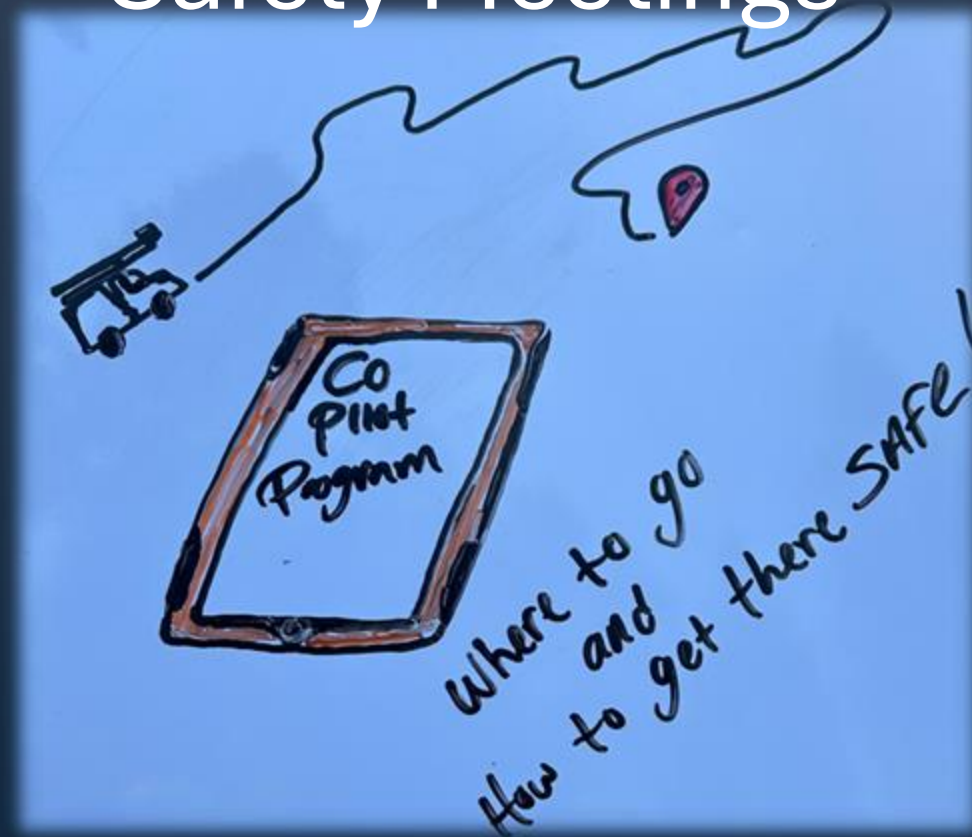

## MFE Home App



## Morning Safety Briefings



07/2025



# Written Program

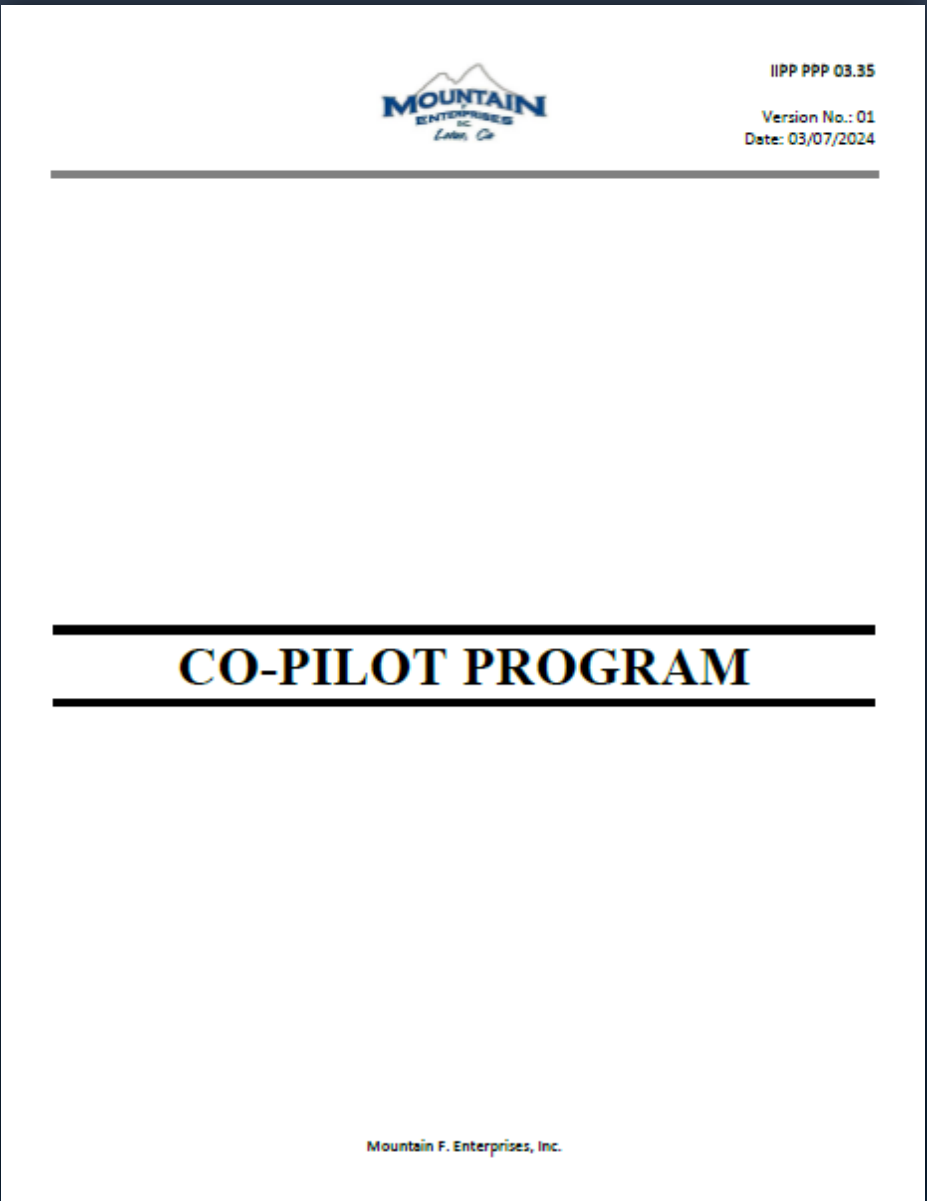

- ✓ Introduction
- ✓ Roles & Responsibilities
- ✓ Training
- ✓ Compliance & Auditing
- ✓ Feedback And Continuous Improvement

A circular inset showing the Table of Contents of the document. The text is as follows:

TABLE OF CONTENTS	
HEALTH & SAFETY (EHS) POLICY	1
POLICY FOR GENERAL INDUSTRY	1
SCOPE AND APPLICABILITY	1
Rationale Behind the Program	1
Commitment to Safety and Excellence	1
ROLES AND RESPONSIBILITIES	2
1.1 Driver Responsibilities	2
1.2 Co-Pilot (Spotter) Responsibilities	2
1.3 Collaborative Effort	2
HAZARD IDENTIFICATION AND COMMUNICATION	3
5.1 Types of Hazards to Identify	3
5.2 Communication Protocol	3
5.3 Best Practices in Hazard Communication	3
5.4 Training for Effective Communication	3
TRAINING PROGRAM	4
6.1 Initial Training	4
6.2 Ongoing Training	4
6.3 Evaluation	4
USE OF TECHNOLOGY	5
7.1 LYTX Camera Systems	5
7.1.2 Compliance and Accountability	5
7.2 Regular Updates and Maintenance	5
7.3 Technological Training and Support	5
COMPLIANCE AND AUDITING	6
Regular Audits	6
Compliance Measures	6
REVIEW AND CONTINUOUS IMPROVEMENT	7
Annual Review	7
INCIDENT AND REPORTING	8
EMERGENCY PROTOCOLS	8
PERFORMANCE AND METRICS	8

07/2025





# Audits/Compliance

---

- Leveraging Existing Tools/Programs for Audits (Lytx/Equipment Share)
- Rewarding The Good
- Identifying The Areas That Need Improvement
- Full Transparency - Sharing Audits With Management



# Audits/Compliance

☑ Does the Co-Pilot have ...	☑ 2. Visually, can you...	☑ 3. Visually, can yo...	☑ 4. Are other passen
Yes	Yes	No	Yes
Yes	Yes	Yes	Yes
Yes	Yes	Yes	Yes
Yes	Yes	Yes	Yes
Yes	Yes	No	Yes

f <sub>x</sub> Question 1 Percentage	f <sub>x</sub> Question 2 Percentage	f <sub>x</sub> Question 3 Percentage	f <sub>x</sub> Question 4 Percentage
25	25	0	25
25	25	25	25
25	25	25	25
25	25	25	25
25	25	0	25
25	25	25	25



## Based On 4 Questions (25 points a piece):

- Does the Co-Pilot have a company phone/tablet in hand?
- Visually, can you see communication between the driver and the Co-Pilot?
- Visually, can you see the Co-Pilot engaged and pointing out directions/hazards?
- Are other passengers alert (i.e.) not sleeping or on their phones?



# Tracking System for Audits

Co-Pilot Program

Audit ▾ MFE Employee List - Active & Achieved Vehicle & Equipment List ▾ + Add or import

7/7-7/11 ▾ 3 hidden fields Filtered by Date of Video Grouped by 1 field Sorted by 1 field Color Share and sync

	Name	Grade	Truck	Employees in Truck
MANAGER	MFE2029 - James Carl Finney 4	Avg 94		
1	RW1-1092 - 07-11-2025	75	RW1-1092	MFE2889 - Jose Padilla-Zarza MFE5989 - Angel Cendejas-Arevalos
2	RW1-911 - 07-10-2025	100	RW1-911	MFE3017 - David Crisanto Castrejon-Arechiga MFE3517 - Hercilio Bejarano-S
3	RW1-1048 - 07-10-2025	100	RW1-1048	MFE4325 - Jafet Medina MFE5425 - Lazaro Vargas-Lara
4	RW1-732 - 07-10-2025	100	RW1-732	MFE4292 - Edwin Javier Diaz-Santiago MFE4326 - Gilberto Fernando Campo
+				
MANAGER	MFE2061 - Gustavo Juarez 3	Avg 92		
MANAGER	MFE2145 - John Prindle Sayre 7	Avg 86		
MANAGER	MFE2245 - Darian Joseph Go 5	Avg 90		
15	RW1-1046 - 07-09-2025	75	RW1-1046	MFE4026 - Yahir I Canas MFE5875 - Jasiel Cabrera-Jimenez
+	Add... - 07-09-2025	100	GPA-31	MFE3086 - Guillermo San Vicente Lazo MFE5874 - Nicholas Ryan Mahurin
64 audits		Avg 93		

- Track/Record Weekly Progress
- Real Time Updates
- Reporting Function

07/2025



# Addition of Two Full Time Internal Employees

---



07/2025





# Weekly Meetings with Senior Management / Field Management

---

- Review collected data
- Discuss findings
- Identify trends or areas requiring attention
- Make adjustments to program protocols if needed
- Allocate additional training if needed
- Review updates to technology
- Execute changes needed in the program

07/2025



# MFE Results

- 2023 MFE PMVI Count – 6
- 2023 PMVI SIF Count – 3
- 2024 MFE PMVI Count – 1 (excluding MFE subcontractors)
- 2024 SIF Count – 0
- 2025 MFE PMVI Count – 2 (excluding MFE subcontractors)
- 2025 SIF Count – 0





# Results

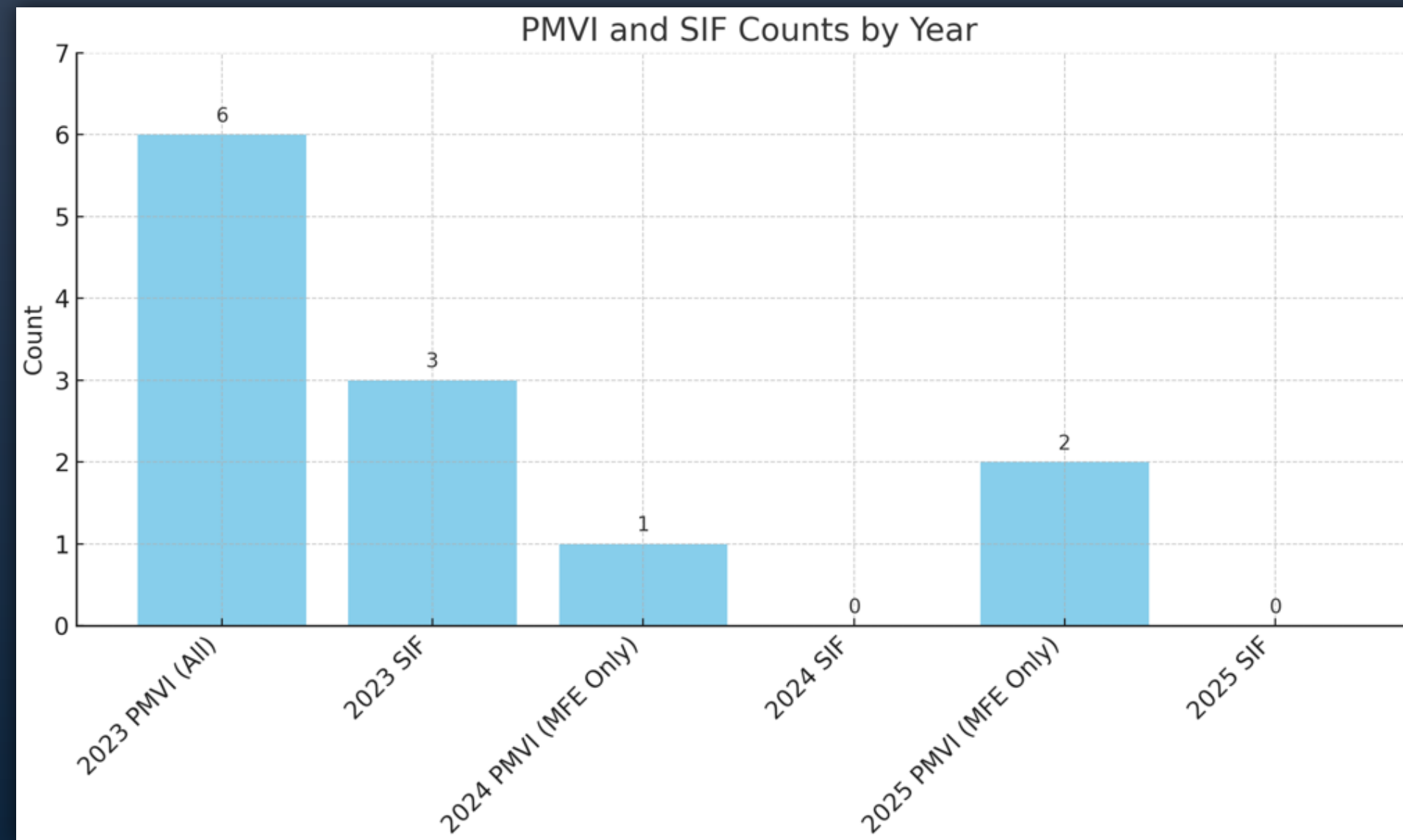

07/2025

# Questions



07/2025







# HIGH-ENERGY SIF REDUCTION

DREW NELSON & LANDON PAINTER



*Pacific Gas and  
Electric Company*®





# DIFFICULT TREE REMOVAL

## Personnel & Communication

- Get to know your crew
- Establish clear roles and communication

## Tree & Location

- Tree assessment is situational and needs to include:
  - Species
  - Health
  - All location factors
  - Equipment
  - Proper equipment selection is key
- Need to know the limitations of both equipment and crew experience
  - Plan & Execute
- Plan can change multiple times throughout the day and you need to adjust accordingly
- Stop and reassess multiple times, including personnel and equipment.







## TREES UNDER TENSION ON CONDUCTORS

- We cannot touch conductors, even de-energized. Incidental line capture with the rigging line mitigates this, the rigging line runs under the power line.
- System involves a degree of prep work. Yes, but we shouldn't be under a time pressure for hazardous work.
- Should the control line be cleated off at the portawrap? No, just enough wraps to hold the load, this enables a worker to pay out rigging control line from a safe distance.
- Can the portawrap be mounted on the log being removed if the crew doesn't have a redirect available. Yes.
- How do you pop the final log off? A pre established tag line to a mechanical advantage setup if necessary. Set where you can get the best pull.
- Does this setup damage the rigging line? Possibly, a webbing sleeve pre-installed prior to tying the bowline can mitigate wear.
- What if the log isn't perpendicular to the power lines and cannot be stood up? The log will need to be rolled off the power lines, after setting the incidental capture rigging line a second tag line should be set below with enough wraps to sufficiently roll the log. Still requires prep work, possibly digging under the log to set rigging or tag lines.
- What if it's a multi stem tree? Secure the biggest stem and start removing the smallest stems.



# LONE WORKER SAFETY

- **Group #1:** Ask neighbors for info, vehicle placard. Develop relationships with individuals, company and less visits
- **Group #2:** Check in/Check out (Text, LiveSafe App, Garmin ect) Pre-Job Briefs that are tailored to individuals. Geo-referenced photo
- **Group #3:** How do you manage "Fit for Duty", Buddy System, Teams call w/ Video requirement
- **Group #4:** Using satellite communication (zolio, spot x, starlink, garmin, rapid, & T-mobile)
- **Group #5:** Check out procedures: Text thread, microsoft Forms, a live SpreadSheet, or app,





## THIRD PARTY THREATS

- After reports are initiated, research into land rights, customer history, failure to keep commitments, "last time left a mess", etc.
- Create case in case management system with notes for risk
- Q: Bad customer info in OneVM, door knocks make customers angry.
- Bundle as often as possible.
- Q: What does de-escalation look like?
- Show up, get on the same level, talk, ask questions, what has happened to bring us here.
- Offer T&M to get all work or extras done, self-checking - be respectful
- Q: Put contractors in PG&E hardhats.
- Keep a kept up appearance, clean vests, clothing etc.
- SCE uses "redlist" database of properties that updates when things change, failure to check before starting work can cause issues, too many work management systems, notes are lost in transition



# Z133/ANSI UPDATES

## **Documented Competency verification Requirement**

Training requirements

Employers must provide supervision and on the job Assessments'

Follow up and documentation requirements

Working together to create a positive Safety Culture

Documented Hazard assessments

Proactive approach to Radio Frequency

Mitigation of Tree Connects

## **Arborist Levels 1-4**

- Level 1 Fundamental education in hazard recognition but Unqualified for any voltages
- Level 2 Qualified for voltages of 750V or less and not working for the purpose of clearing space for supply lines.
- Level 3 Qualified for Voltages up to 35kv, demonstrated competency
- Level 4 Qualified for all voltages and working on behalf of a utility.

## **Updates:**

- JHA for Storm work and Conductors that are bonded and grounded.
- All power saws require 2 hands
- Language change from Tree Worker to Arborist



# THANK YOU FOR JOINING US!

On behalf of all of our  
Sponsors and the Utility  
Arborist Association –  
THANK YOU for joining us  
at this years Safety  
Summit!

**PLEASE FILL OUT  
OUR SURVEY!**

California Safety Summit Survey -  
2025

